

# Plastkeðjur

## Plastkeðja bein

Tegund	K	TT	H
LF 820 K 325	82.5	4	9,5
LF 820 K 400	101.6	4	9,5
LF 820 K 450	114.3	4	9,5
LF 820 K 600	152.4	4	9,5
LF 820 K 750	190.5	4	9,5

Allar tölur í mm

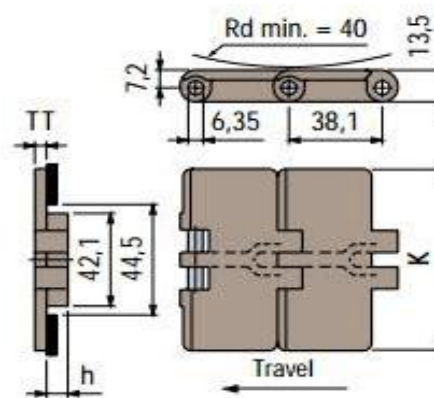

## Plastkeðja bein

Tegund

K

LF 821 K 750

190.5

LF821 K 1000

254.0

LF821 K 1200

304.8

Allar tölur í mm

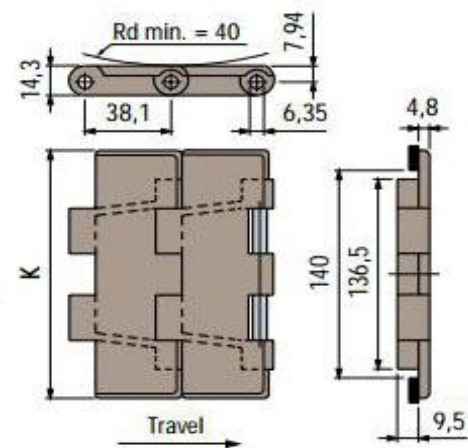

## Tannhól fyrir plastkeðju LF 820 og 821

### KUS 820

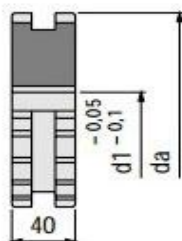

### Split Thermoplastic (KUS) Sprockets

Rexnord Order No.	No of Teeth		Pitch Dia. d mm	Outside Dia. da mm	Finished Bore with Keyway d1 mm	Weight kg
	Actual	Effective				
KUS 820 T19 R...*	19	9,5	117,35	117	20* 30 35 40	0,40
KUS 820 T21 R...*	21	10,5	129,26	129,5	20* 30 35 40	0,50
KUS 820 T23 R...*	23	11,5	141,22	142	20* 30 35 40	0,60
KUS 820 T25 R...*	25	12,5	153,21	154,2	20* 30 35 40 50 60	0,74
KUS 820 T27 R...*	27	13,5	165,21	166	20* 30 35 40	0,88

\* = Available upon request and minimum order quantity.  
 • = Plain Bore. Without keyway. Tolerance d1 =  $\begin{matrix} +0,3 \\ 0 \end{matrix}$   
 Material: sprocket in polyamide (black).  
 Bolts and nuts in stainless steel AISI 304.

Keyway: UNI 6604-69. See page 101.  
 Max recommended tightening torque: 1 kgm.  
 Half-section fixing nuts (self-locking).

### KU 820

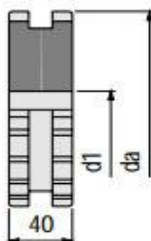

### Thermoplastic (KU) Sprockets

Rexnord Order No.	No. of Teeth		Pitch Dia. d mm	Outside Dia. da mm	Plain Bore B mm	Max. Bore mm	Weight kg
	Actual	Effective					
KU 820 T19 R20*	19	9,5	117,35	117	20	60	0,40
KU 820 T21 R20	21	10,5	129,26	129	20	67	0,50
KU 820 T23 R20*	23	11,5	141,22	142	20	75	0,61
KU 820 T25 R20	25	12,5	153,21	154	20	80	0,74
KU 820 T27 R20*	27	13,5	165,21	166	20	85	0,88

\* = Available upon request and minimum order quantity.  
 Material: polyamide (black)

## Plastkeðja beygja

### Tegund

LF 880 K 325 TAB

LF 880 K 450 TAB

Allar tölur í mm

	K	TT	G	H	R
LF 880 K 325 TAB	82,5	4	11,5	16	457
LF 880 K 450 TAB	114,3	4	11,5	16	500

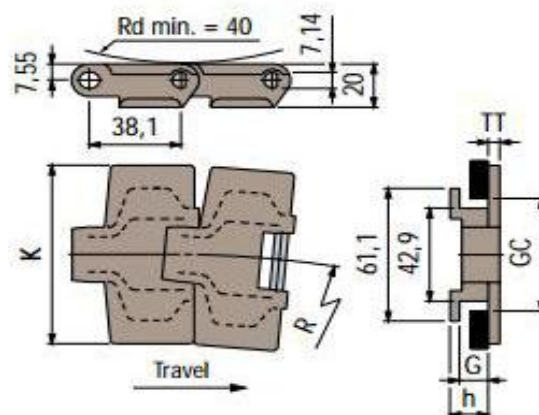

## Plastkeðja beygja

### Tegund

LF 880 K 325 BEV

LF 880 K 450 BEV

Allar tölur í mm

	K	TT	G	R
LF 880 K 325 BEV	82,5	4	16	457
LF 880 K 450 BEV	114,3	4	16	457

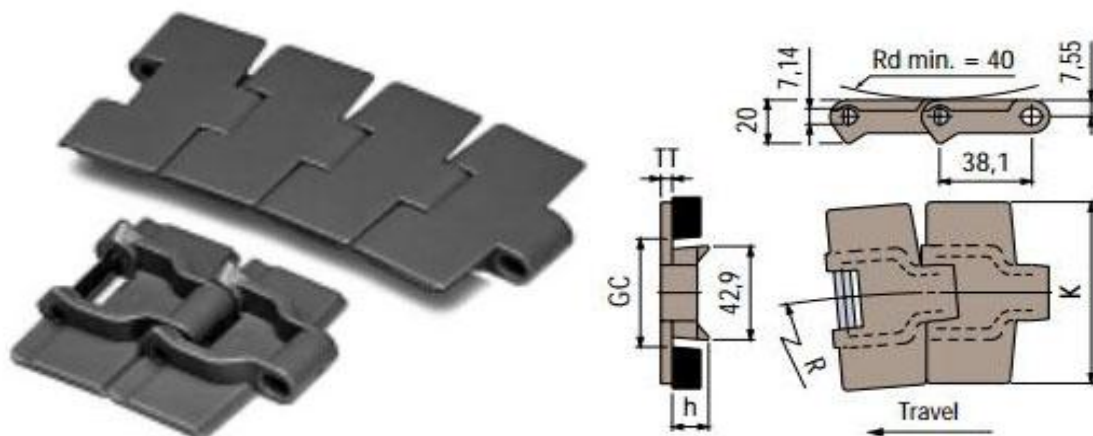

## Plastkeðja beygja

Tegund	K	R
LF 882 K 750 TAB	194.5	610
LF 882 K 1000 TAB	254	610

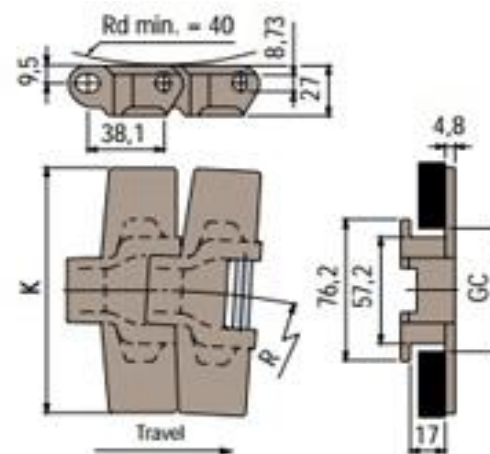

## Plastkeðja beygja

### Tegund

LF 882 K 750 BEV

LF 882 K 1000 BEV

Allar tölur í mm

	K	R
LF 882 K 750 BEV	194.5	610
LF 882 K 1000 BEV	254	610

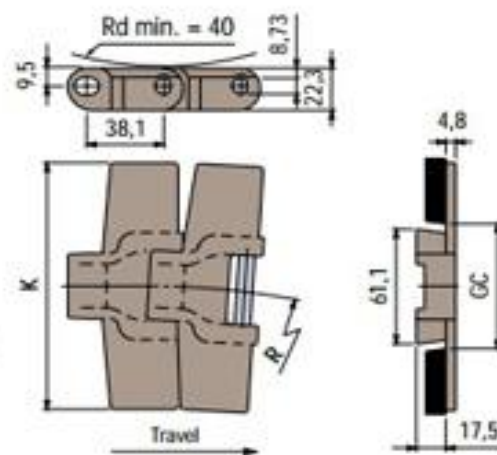

## Tannhjól fyrir plastkeðju LF 880 og 882

### KU 880

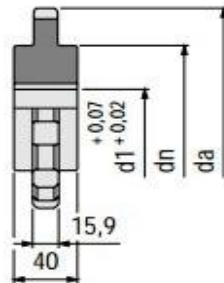

### NS 880

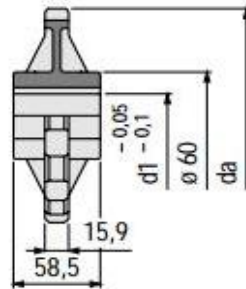

### Thermoplastic (KU) Sprockets

Rexnord Order No.	No of Teeth		Pitch Dia. d mm	Outside Dia. da mm	Finished Bore with Keyway d1 mm	dn mm	Weight kg
	Actual	Effective					
KU 880T10 R...*	10	10	123,29	122,5	20* 30 35 40	80	0,28
KU 880T11 R...*	11	11	135,23	135	20* 30 35 40	85	0,35
KU 880T12 R...*	12	12	147,21	147,4	20* 30 35 40	90	0,42

\* = Available upon request and minimum order quantity.

Keyway: UNI 6604-69. See page 101.

• = Plain Bore. Without keyway. Tolerance d1 =  $\begin{matrix} +0,3 \\ 0 \end{matrix}$

Material: polyamide (black).

### Split Thermoplastic (NS) Sprockets

Rexnord Order No.	No of Teeth		Pitch Dia. d mm	Outside Dia. da mm	Finished Bore with Keyway d1	Weight kg
	Actual	Effective				

#### Bore (mm)

NS 880T10 R...*	10	10	123,29	122,5	25 30 35 40 45	0,30
NS 880T12 R...*	12	12	147,21	147,4	25 30 35 40 45	0,37

#### Bore (inch)

NS 880T12 R...*	12	12	147,21	147,4	1" 11/4"	0,37
-----------------	----	----	--------	-------	----------	------

\* = Available upon request and minimum order quantity.

Keyway: UNI 6604-69. See page 101.

Max recommended tightening torque: 1 kgm.

Material: sprocket in reinforced polyamide (black).  
Bolts in stainless steel AISI 304, nuts in nickel plated brass.



## Hryggjarliðakeðja

**Tegund**  
WLF 1703  
Allar tölur í mm

**R**  
140

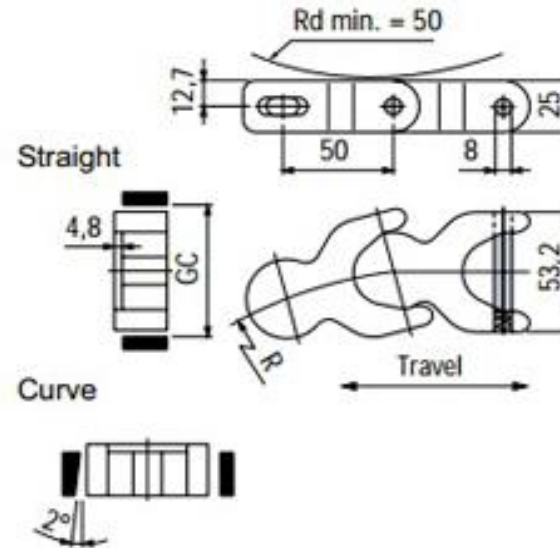

## Tannhjól fyrir hryggjaliðakeðju

**N 1700 AS**

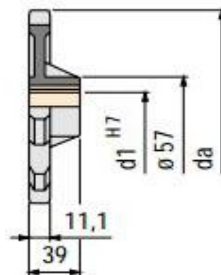

### Thermoplastic (N) Sprockets

Rexnord Order No.	No of Teeth	Pitch Dia. d mm	Outside Dia. da mm	Finished Bore with Keyway d1 mm	Weight kg
N 1700 AS T10R...*	10	161,8	165,1	24 25 30	0,40

\* = Available upon request and minimum order quantity.  
Material: polyamide (white). Brass hub.  
Keyway: UNI 6604-69. See page 101.

## Hliðarstýring með rúllum



Sideflexing

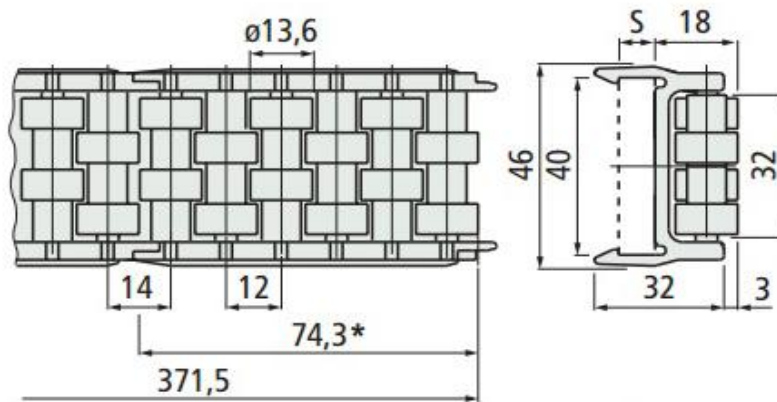

\* = module length

- Fixing with plate.

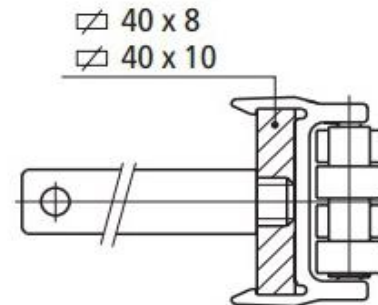

• Min. curvature radius Part. 580

- Fixing with metal profile Part. 537.

